

TABLE OF CONTENT

Content	Pages
Introduction	1
People and Nature	1
Enforcing Issues	1
The disease of hunger	1
Searching the woods	2
Little achievement	2
Fully Succeed	2
Final destination Reached	3
Recommendation	3
Figure 01 Field work report	4 4
Figure 02 Field work report	5 5
Rules on water usage	6
Acknowledgement	7

BRIEF BACKGROUND OF BARANA COMMUNITY.

PEOPLE and NATURE

"Save it, it serves"

Introduction

Water, food, shelter and clothing are the important part for our living today.

people move from place to place ~~long~~ to live togetherness with these needs and wants in life. But where can it be found? Nature can show us, live by it and work alongside it.

Enforcing Issues.

Demanding issues due to Selfish-ness. There were many Human impacts in life ~~to~~ nowadays. Expanding capital cities and Towns, population growth within those years causing problem with the Contamination of rivers and stream with waste chemical from the ~~a~~ large factories and using some parts of the land as dumping Sites from man-made waste, leaving bare lands with unfertile soil for gardening. This impacts forcing many of our type's to leave their home and communities and find some other places to free from all this impacts.

The Disease of Hunger.

In 1960 the disease of hunger for all this needs and wants arise within ~~the~~ few of our community, villages and homes, due to lack of fresh water from the water sources and food from the land, trees, rivers and also within the ocean. Few families left the village and community which they move further inland, in search for the recovery ~~the~~ of their hunger's. This usually happen between 1960 to 1970 to our very own people of our community.

Searching the woods.

By 1960 to 1965 many people leave their homes and villages in searching for better living in the woods which they try to yield good food, fresh water, little income and shelter.

Little achievement gain the year 1965, living together in one place which create community and working together in care for the sources of life had to be achieved.

Little achievement.

Life is good optically, by living with the nature.

They have to earn ~~little~~ few incomes with the good they produce in order to be fully succeed, but this yet to be solved.

Carrying heavy loads of products they produce and walk for several kilometers to the buyers are their burden for them.

Fully Succeed

Ten solid years of struggle, access roads for vehicle transport were being imaged for some other purposes from the city.

Relocation from the first community took place in the year 1970-1975 and they sheltered themselves near to this access roads. Difficulties of earning income with heavy load carried and walked for many kilometers has now been solved.

Final Destination reached.

Finally the year 1975-1980 the Barana Community people successfully overcome the disease of hunger for those issues which is that the NATURE ~~provid~~ provides for them. More clean fresh water sources, More fertile soil for gardening and plenty food from the trees and waters are available within the nature which the community live by it.

Recommendations.

For the people of Barana community, as you were situated partly of the Nature and Heritage park which it says "Ecosystem-based-adoption to climate change" was your priority to achieve in order to save the life of our future generation. So!

- stop littering of non-rotted waste within the natural resources
- over-harvesting of trees/forest
- stop Contaminating of rivers and streams with chemicals
- Slow-down the growth rate population ~~the~~ of the community

Save the Nature as it serves for you, your family and your community as a whole.

Fig. 02. Enforcement to Final destination reach.
(Time Line movement)

Field work report

Time (in years) Events that take place.

- 1960
 - Expansion of Town Boundaries
 - Miss Matanika village
 - Over Populated took place along matanika river
 - Dump site of man-made waste (bare lands)
 - Contamination of river and shore line (ocean)

- 1960-1965 → Movement of people into the thick forest jungle
 - Enforcement cause by disease of hunger.

- 1965
 - First Community settlement of Barana Community
 - little achievement
 - Carry heavy load of good and walked several kilometers to the market.
 - life is good living with Nature.

- 1965-1970 → Movement further inland
 - Move closely to new road access

- 1970
 - access road fully Constructed
 - relocation from first village take place
 - forming New Barana Community

- 1970-1975 → Final destination reach
 - No longer walk several kilometers to town
 - Everyone live happen with their New Village -

Field work Report

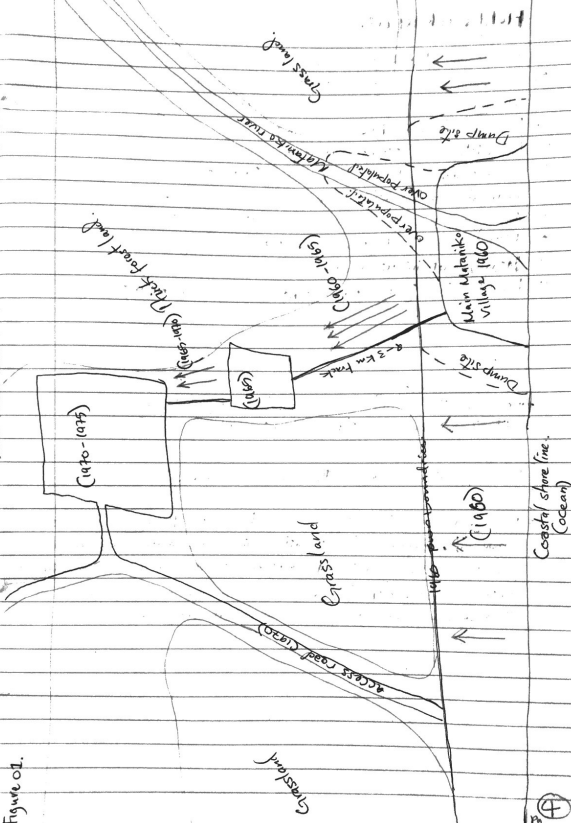

Figure 01.

Fig 19.02. BAKANA COMMUNITY With the... Water Sources
Land Blocks for gardening that surrounded it.

Field work report.

Water source name	uses
1. Kaho	→ Drinking only
2. Vatumanu	→ Washing, Swimming, Cooking water
3. Vuvura	→ " " "
4. Tuvuloki	→ Washing, Swimming
5. Tuvu fetelo	→ Washing, Swimming
6. Water pump	→ " " Cooking
7. Poresii	→ Drinking, Cooking, Washing Swimming
8. Mataga	→ " " " "
9. Kokou	→ Drinking, Swimming
10. Iqemane	→ Swimming.
11. Koo Nani	→ Drinking, Washing, Cooking, Swimming

land Blocks

→ all of this land are suitable for gardening.
It is preserve as the gardening sites.

Recommendation on using those water sources.

⇒ If I could take this chance to kindly urge the people of this community. Before and after using this source always ensure that you don't litter or left any waste matters along and within the water sources. Kept it clean so that we could be free from all sicknesses causing by unclean water sources.

Field work Report.

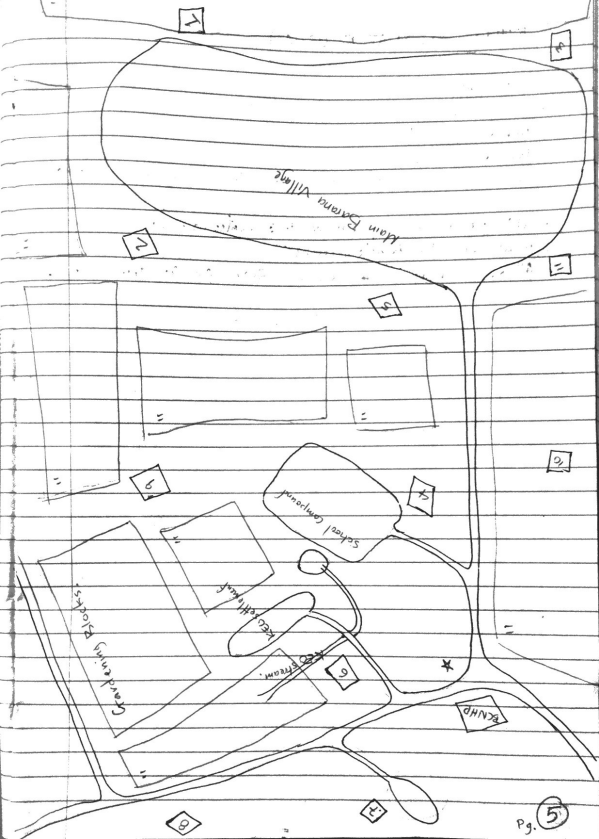

RULES ON WATER USAGE

- ① Clean up
2. Use it wisely
3. Respect for water
4. Reserve if not enough
5. Women are not allowed to be on waters during late evening hours
6. GENDER BALANCE - few of this water sources are allowed to use only by female persons
7. All waste disposal must be 30m far from the source